

Roof fan

DTH20041EC

DTH20041EC

Roof fan with horizontal exhaust with openable housing. DTH is made from cast aluminium, giving it a high corrosion resistance. DTH can be mounted on roof cowl TKG/TGR.



PRODUCT BENEFITS

- High corrosion resistance
- Backward curved blades
- High efficiency
- Low operating costs
- Can be mounted on roof cowl TKG/TGR

Product description

DESCRIPTION:

The DTH roof fan is an extraction ventilator manufactured in cast aluminium, ensuring long-term, problem-free operation. TKG/TGR roof cowls are available for this, ensuring simple and correct ventilation.

The DTH roof fan has a backward-curved B impeller in aluminium with a horizontal air exhaust and can be opened for cleaning. DTH is available in 5 sizes: DTH160, -200, -250, -315 and -400.

MOTORS:

DTH160 and -200 have a single-phase motor, while the other models have an EC motor.

TEMPERATURE:

In normal operation, DTH tolerates temperatures up to 60 °C.

Combustion-gas fan

If a certified fire gas fan is required, we refer to SEF roof fan.

Accessories

Description	Variants
MAC12 constant pressure regulator	MAC12
EFC15, electronic regulator	EFC15
HW050X08002U0UL	SWDTH
HW050X08002U0UL	EFC1P2

Fan data

Max. Total efficiency (A-D) (%)	38,5
Ventilation energy class - Average climate	C
Efficiency level requirements	62, N(2015)
ECO efficiency level during optimal operating point	70,7
Nominal speed (RPM)	1400
Power supply	1x230 V - 50Hz
Overload protection	Integral thermal cutout (TP211) in motor power circuit
Engine power (kW)	0,04

Roof fan
DTH20041EC
DTH20041EC

Dimensional data

A (mm)	225
B (mm)	365
C (mm)	260
D (mm)	70
E Ø (mm)	200
Weight (kg)	13

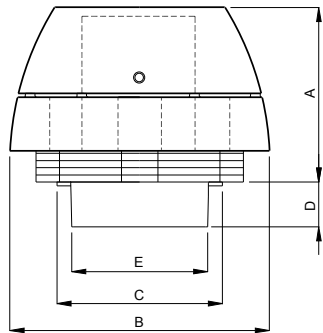

Installation
DTH fans are designed for use with TGR or TKG roof vents, for simple and optimal installation.

DTH is simply lowered over the roof vent, and its weight holds it in place. Vibration-damping materials are also supplied to ensure that vibrations from DTH are not transferred to the duct system.

TGR and TKG roof vents are insulated for sound and condensation and have an integral cable penetration. As an accessory an AOR anti-back-draught shutter and bracket can be selected.

Electrical datas

Frequency (Hz)	50
Max. current (A)	0,35
Voltage (V)	1x230
Engine power (kW)	0,04

Regulatory data

Ventilation energy class - Average climate	C
--	---

Installation

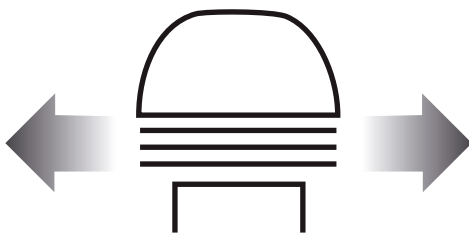

DESIGN
The DTH is made of cast aluminium, which gives it a high corrosion resistance (Corrosion class C4 according to EN ISO 12944-2).

It is painted in black RAL 7021, a suitable colour for most roofs.

HORIZONTAL EXHAUST
DTH is an extract fan with a horizontal exhaust.

The design ensures an optimum air handling solution with minimum noise.

FAN IMPELLER
DTH roof fan is ideal for ventilation tasks requiring efficient and economical ventilation.

The specially developed centrifugal impeller with backward curved blades ensures high efficiency and low operating costs.

Roof fan

DTH20041EC

DTH20041EC



SERVICE
DTH roof fan is easy to open for cleaning and maintenance.

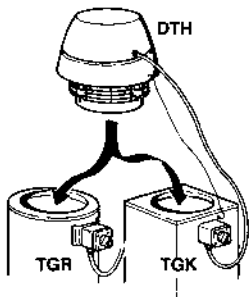

DTH fans are designed for use with TGR or TGK roof cowls, for simple and optimal installation.

DTH is simply lowered over the roof cowls, and its weight holds it in place. Vibration-damping materials are also supplied to ensure that vibrations from DTH are not transferred to the duct system.

TGR and TGK roof cowls are insulated for sound and condensation and have an integral cable penetration. As an accessory an AOR anti-backdraught shutter and bracket can be selected.

Curve

